

112T SCHEMATIC

KIT-A

SEAL RING(2)

O-RING(2)

PLUNGER GUIDE(2)

RETAINER PLATE(2)*

PLUNGER(1)

KIT-B

O-RING(4)

VALVE(4)

WASHER(8)

*NOT INCLUDED IN KIT-A

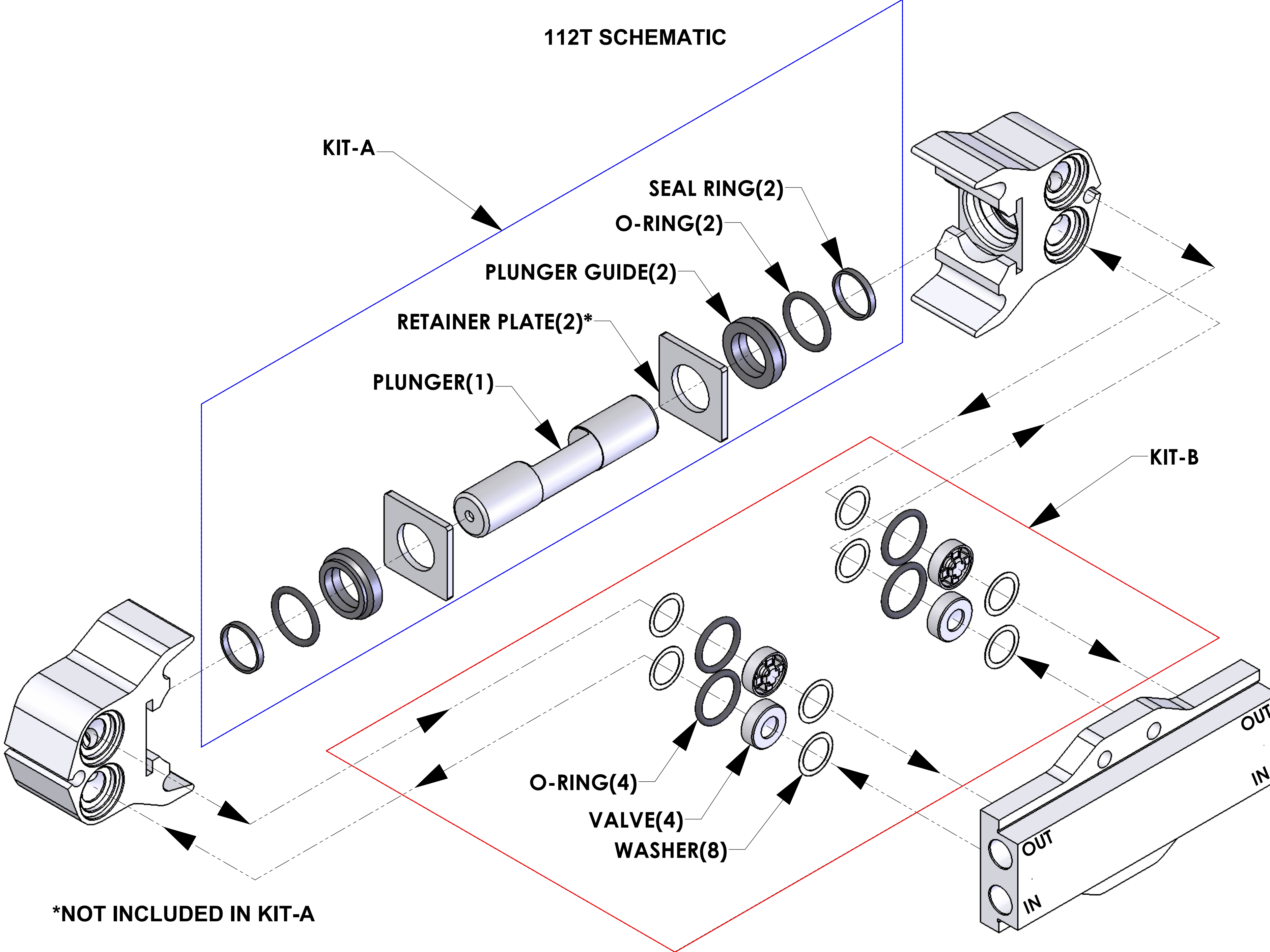

KIT-A

PART NUMBER DESCRIPTION

10001	KIT-A, PLUNGER & SEALS, 112T/114T, BUNA
10005	KIT-A, PLUNGER & SEALS, 112T/114T, VITON

RETAINER PLATES NOT INCLUDED IN KIT-A.
BROWN O-RINGS INDICATE VITON
BLACK O-RINGS INDICATE BUNA

KIT-B

10004	KIT-B, VALVE & SEALS, 112/113, FOR METAL POPPET VALVES, BUNA
10008	KIT-B, VALVE & SEALS, 112/113, FOR METAL POPPET VALVES, VITON
10012	KIT-B, VALVE & SEALS, 112, FOR PLASTIC POPPET VALVES, BUNA
10018	KIT-B, VALVE & SEALS, 112, FOR PLASTIC POPPET VALVES, VITON

BROWN O-RINGS INDICATE VITON
BLACK O-RINGS INDICATE BUNA

PUMP WITH MOUNTING BOLTS.

60001	112T PUMP ONLY, BUNA, METAL POPPET VALVE, 4 - 1/4" PORTS, BLUE
60002	112T PUMP ONLY, BUNA, PLASTIC POPPET VALVE, 4 - 1/4" PORTS, BLUE
60003	112T PUMP ONLY, VITON, PLASTIC POPPET VALVE, 4 - 1/4" PORTS, BLUE
60004	112T PUMP ONLY, BUNA, METAL POPPET VALVE, 4 - 1/4" PORTS, E-COAT GD/BK
60005	112T PUMP ONLY, BUNA, PLASTIC POPPET VALVE, 4 - 1/4" PORTS, E-COAT GD/BK
60009	112T PUMP ONLY, VITON, METAL POPPET VALVE, 4 - 1/4" PORTS, BLACK
60011	112T PUMP ONLY, VITON, PLASTIC POPPET VALVE, 4 - 1/4" PORTS, BLACK

CAM BEARING & MOTOR NOT INCLUDED.