

Operations Manual

Cleanfix[®] Air Mover



This unit is intended for commercial use

This manual is furnished with each new **Cleanfix[®] Air Mover (Model HBA2500)**. It provides necessary operation and maintenance instructions.

READ AND FOLLOW ALL INSTRUCTIONS, WARNINGS AND CAUTIONS BEFORE AND WHEN USING THE AIR MOVER.

All information and specifications printed in this manual are current at the time of printing. However, because of Cleanfix's policy of continual product improvement, we reserve the right to make changes at any time without notice.

WHEN THE MACHINE IS DELIVERED

This Air Mover will afford you many years of trouble-free operating satisfaction, provided it is given proper care. All parts are passed rigid quality control standards prior to their being assembled to the finished product. Prior to packaging, your Air Mover was again inspected for assurance of flawless assembly.

The Air Mover is protectively packed to prevent damage in shipment. When machine is delivered carefully check the carton for signs of damage.

Remove the machine from the carton. If the machine is damaged, notify the carrier immediately and request an inspection. As a shipper we are unable to report any claim for damage. You must origin any claim within 5 days of delivery. Be sure to keep the carton, packing inserts, packing list and carrier's receipt until the inspector has verified your claim. **CLEANFIX'S LIABILITY CEASES WHEN THE SHIPMENT IS PICKED UP BY THE CARRIER.** Cleanfix will furnish any information needed to expedite the claim process.

WARRANTY

The unit will be guaranteed to be free from defects in materials and workmanship under normal use and service for a period of one (1) year including the pump and vacuum.

The fiberglass housing will have a three (3) year warranty. The warranty does not apply to (a) damage in shipping, (b) alteration by unauthorized repair, (c) failure caused by lack of proper maintenance and cleaning, (d) misuse and abuse. Normal wear and tear parts such as switches, power cords, and machine finish of which the use cannot be controlled are not included.

Before sending a machine back for warranty or machine repair, contact your local distributor where you purchased the equipment to make arrangements on the repair of the equipment. The distributor will obtain a return authorization number from Cleanfix for warranted parts and facilitate the repair of the equipment. Replace damaged or worn parts only with Cleanfix original replacement parts to maintain safety and to protect your warranty.

GENERAL PRECAUTIONS

FAILURE TO FOLLOW PRECAUTIONS AND WARNINGS MAY CAUSE SERIOUS INJURY TO THE OPERATOR AND CAUSE DAMAGE TO MACHINE, WHICH CAN VOID WARRANTY. TO REDUCE RISK OF FIRE, ELECTRIC SHOCK OR INJURY: READ ALL INSTRUCTIONS BEFORE AND WHEN USING THIS AIR MOVER.

- For 120 volt grounded outlet models. The unit must be plugged into a properly grounded outlet. **Do not** operate the machine with a broken/missing grounding pin. Have a qualified service person replace the plug immediately.
- **Do not** leave the Air Mover when plugged in. Unplug from outlet when not in use and before servicing.
- To avoid electric shock **Do not** use outdoors or on wet surfaces.
- This is **NOT** a toy. Close attention is necessary when used around or near children.
- Use only as described in this safety/operations manual.
- **Do not** use this Air Mover with damaged cord or plug. If the Air Mover is not working as it should, because it has been dropped, damaged, left outdoors or dropped into water, contact authorized service center or factory.
- **Do not** pull or carry by the cord, use cord as a handle, close a door on cord or pull cord around sharp edges and corners. **Keep cord away** from heated surfaces.
- **Do not** unplug the Air Mover by pulling on the cord. To unplug, grasp the plug, not the cord.

GENERAL PRECAUTIONS (continued)

- **Do not** handle the plug of the Air Mover with wet hands.
- Store Air Mover indoors in a dry area.
- **Do not** put any objects into openings. **Do not** use with any opening blocked; keep free of anything that may reduce air flow.
- Keep hair, loose clothing, fingers, and all parts of body away from openings and moving parts.
- Turn **OFF** all the controls before unplugging.
- **Do not** use where anesthetics or oxygen is used. **Do not** operate the machine where explosive vapors or flammable materials exist.
- **Do not** use an extension cord unless absolutely necessary. If an extension cord is used, then wire size must be 14 ga. or larger and should not exceed 50 feet in length. The extension cord must be three-wire type to insure grounding protection.
- Replace damaged or worn parts immediately with genuine original equipment parts to maintain safety and to protect your limited warranty.

WARNING

DO NOT Place in standing water.

GROUNDING INSTRUCTIONS - 120 VOLT

Improper use of the grounding plug can result in a risk of electric shock.

Electrical equipment must be grounded. If it should malfunction or breakdown, grounding provides a path of least resistance for electrical current to reduce the risk of electric shock.

The blower is equipped with a cord having equipment grounding conductor and grounding plug. The plug must be inserted into an appropriate outlet that is properly installed and grounded in accordance with all local codes and ordinances.

If repair or replacement is necessary, **DO NOT** connect the grounded wire to either flat blade terminal. The wire with insulation having an outer surface that is green with or without yellow stripes is the grounding wire.

WARNING

Improper connection of the equipment-grounding conductor can result in a risk of electric shock. Check with a qualified electrician or service person if you are in doubt as to whether the outlet is properly grounded.

Do not modify the plug provided with the equipment. If it will not fit the outlet, have a proper outlet installed by a qualified electrician.

Note: In Canada, the use of a temporary adapter is not permitted by the Canadian Electrical Code.

GROUNDING METHODS

This electric equipment is for use on a nominal 120-volt circuit and has a grounded plug that looks like the plug illustrated in (Fig. A). A temporary adaptor that looks like the adaptor illustrated in (Fig. B & C) may be used to connect this plug to a 2-pole receptacle as shown in (Fig. B) if a properly grounded outlet is not available.

The temporary adaptor should be used only until a properly grounded outlet (Fig. A) can be installed by a qualified electrician. The green color rigid ear, lug or the like extending from the adaptor must be connected to a permanent ground such as a properly grounded outlet box cover. Whenever the adaptor is used, it must be held in place by a metal screw.

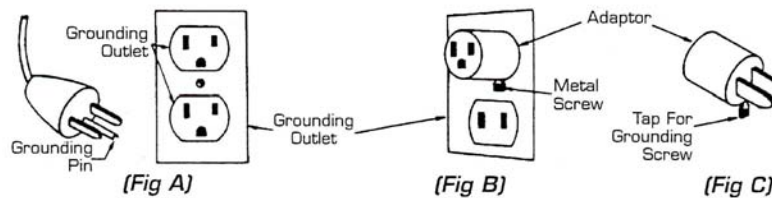

DANGER:
Improper use of the grounding plug can result in a risk of electrical shock.

DRYING INSTRUCTIONS

<p>Use this method when the carpeting is glued and you cannot place Air Mover underneath the carpet.</p> <ol style="list-style-type: none"> 1) Place the Air Mover in a corner pointing toward the center of the room. 	<ol style="list-style-type: none"> 2) Turn the switch knob to select the speed you want. 3) The air blows over the surface to speed evaporation. Move the Air Mover periodically as the surface dries.
---	--

FLOODED AND STRETCHED CARPET

<p>If stretched (non-glued) carpet becomes completely saturated due to flooding or pipes breaking, use this method to dry the carpet's backing. Only a professional should perform this procedure.</p> <ol style="list-style-type: none"> 1) Remove all the furniture from the room. 2) Lift an edge of the carpet and slide the exhaust side of Air Mover under the carpet. 	<ol style="list-style-type: none"> 3) Plug Air Mover into a grounded outlet and turn it ON. This forces the air under and through the carpet to speed drying time. The will billow in the center. 4) Remove Air Mover when the carpet is dry and stretch carpet back into place.
--	--

AIR MOVER REPLACEMENT PARTS LIST

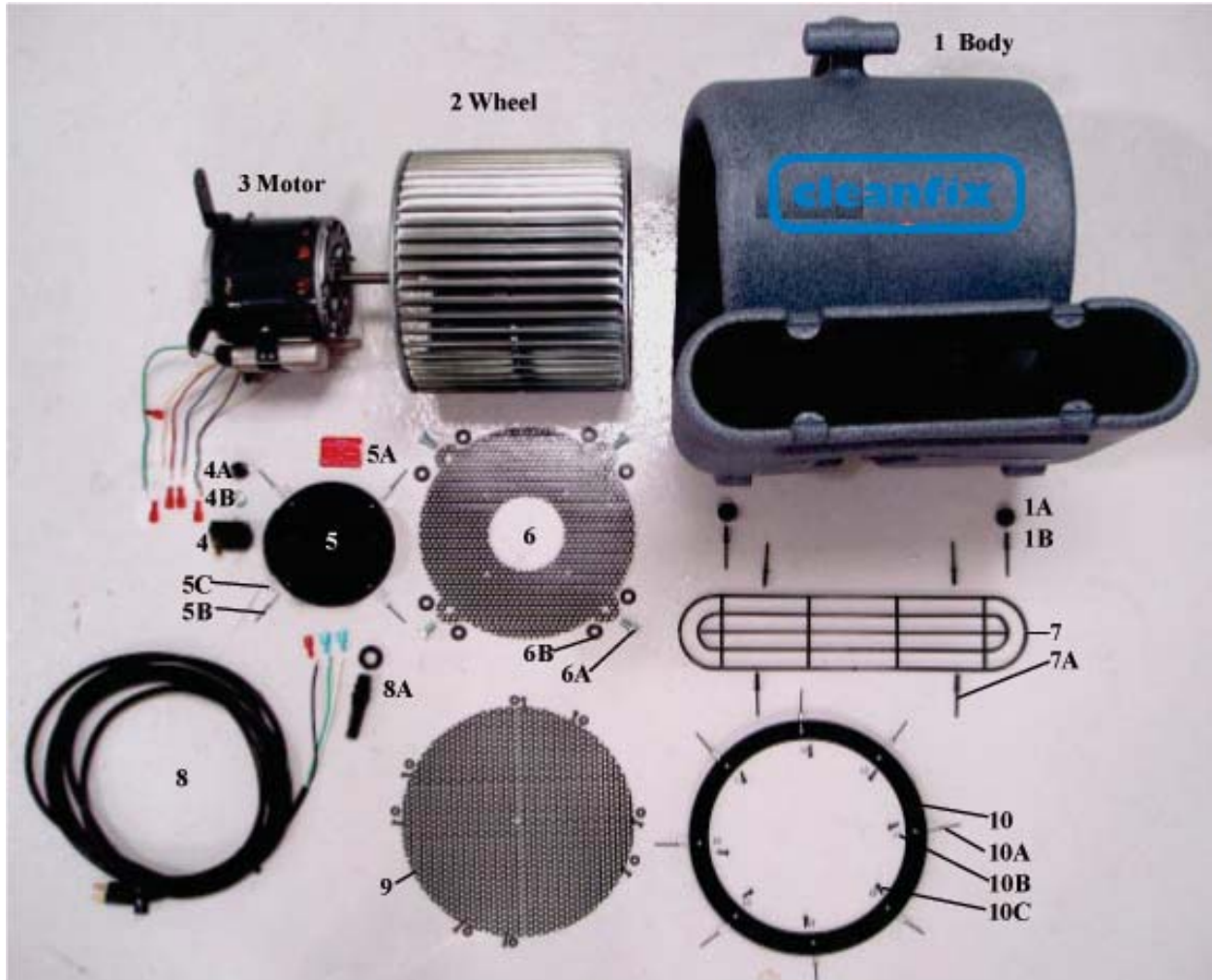

Ref. No.	Part Description	Part No.	Ref. No.	Part Description	Part No.
1	Main Body	2501	6A	Motor Bolt	2506A
1A	Feet/Bumper	2501A	6B	Motor Washer	2506B
1B	Bumper/Rivet	2501B	7	Finger Guard	2507
2	Fan Wheel	2502	7A	Rivet	2507A
3	1/2hp Motor	2503	8	Cord	2508
4	Rotary Switch	2504	8A	Strain Relief	2508A
4A	Switch Knob	2504A	9	Intake Screen	2509
4B	Switch Nut	2504B	10	Venturi Ring	2510
5	Switch Housing	2505	10A	Venturi Rivet	2510A
5A	Warning Label	2505A	10B	Venturi Washer	2510B
5B	Switch/Rivet	2505B	10D	Venturi Screw	2510C
5C	Switch/Washer	2505C			
6	Motor Screen	2506			

New Machine Warranty



1. Limited Warranty. These terms and conditions of the New Machine Warranty are a material part of the agreement between Buyer and Cleanfix Cleaning Systems Inc., a New Jersey-based corporation (hereinafter "Cleanfix"), and supersede warranty terms and conditions in documentation submitted by Buyer to Cleanfix. Cleanfix warrants new machines of its manufacture against defects in material and workmanship under normal use and service to the original end-user purchaser. No person, agent, representative or distributor is authorized to give any warranties on behalf of Cleanfix, or to assume any other liability for Cleanfix in connection with any Cleanfix machine. Cleanfix reserves the right to make changes to its equipment without notice. The warranty coverage is subject to the conditions below.

2. Registration of Warranty. The warranty commences on the date of purchase by the original end-user from an authorized Cleanfix distributor or agent, subject to proof of purchase. The warranty commences latest, however, after six (6) months of the purchase date by the authorized distributor or agent of Cleanfix. Any new Cleanfix machine must be registered immediately with Cleanfix by the original end-user customer by fully completing and returning the warranty registration form to Cleanfix. If proof of purchase cannot be identified through a completed and returned warranty registration form, the warranty commences from the date of sale to the authorized Cleanfix distributor.

3. Warranty Coverage. Subject to conditions outlined below, Cleanfix warrants rotationally molded PE housings and tanks on all of its machines to be free from defects in material and workmanship, under normal use and service for ten (10) years to the original end-user.

Subject to conditions outlined below, Cleanfix warrants fiberglass housings and tanks on all of its machines to be free from defects in material and workmanship, under normal use and service for three (3) years to the original end-user.

Under this warranty Cleanfix warrants the performance of non-polyethylene and non-fiberglass components to be free from defects and workmanship for up to one (1) year to the original end-user. Parts replaced or repaired under this warranty are warranted for the remainder of the original warranty period. (See table below)

Rotationally molded PE housings and tanks	10 years
Fiberglass housings and tanks	3 years
Vacuum motors, brush motors, pump motors, boards and electronics	1 year
Battery and battery charger*	1 year

* The 1 year period warranty commences with the purchase date by the authorized distributor or agent of Cleanfix.

Service labor charges are covered for up to one (1) year from the date of purchase through an authorized Cleanfix service provider. A total maximum of one (1) hour travel time - equal to one (1) hour labor rate - is covered for large machines, namely Falcon, Raven, Eagle and larger for 90 days. No coverage is extended for diagnosis time.

4. Product Exceptions and Exclusions. ALL vacuum cleaners and air movers are warranted for one (1) year. No warranty is extended for wear items, accessories and attachments including, but not limited to, belts, brushes, pad holders, capacitors, carbon brushes, wheels, casters, glides, clutches, cords, filters, filter bags, gaskets, hoses, rectifiers, switches, float switches, valves, squeegees, bearings, pulleys, relays, actuating cables, wheels, tires, vacuum cleaner attachments.

The purchaser is assured that meticulous care has been exercised in the selection, assembling and testing of these parts and components before shipping. No warranty is extended for machine finish, labels and other cosmetic parts or features.

5. Stated Warranties. Stated warranties are in lieu of all other warranties, expressed or implied. Any statutory implied warranties, including any warranty of merchantability or fitness for a particular purpose, are expressly limited to the duration of the written warranty. Cleanfix will not be liable for any other damages, including but not limited to incidental, indirect or special consequential damages arising out of or in connection with the furnishing, performance, use or inability to use the machine, including damages to persons or property. This remedy shall be the exclusive remedy of the buyer. The warranty is limited to the warranty.

6. Warranty is null and void for the following.

- Damage, defects, malfunction or other failures caused by not using the electric current indicated on the spec plate, including the use of improper extension cords.
- Damage or defect caused by accident, misuse, neglect, abuse, fire etc., including use of incompatible or corrosive chemicals or overloading of capacity.
- Failure caused by lack of proper maintenance and care, including proper machine clean-up after use, proper charging procedures for batteries.
- Failure caused by loss, damage or removal of protective components, including, but not limited to, filters and filter screens, tank covers and lids, skirts and bumpers, float shut-off assemblies.
- Freezing of any water or chemical related components (this will void all warranties on water or chemical related components, internal or external, of the product).
- Deposits and buildup in any water or chemical related systems due to hardness in water (this will void all warranties on affected systems).
- Any design alterations, adjustments and/or repairs performed on the equipment by an organization not authorized or specified by Cleanfix.
- Use of any parts not approved by Cleanfix, including, but not limited to, batteries, battery charger, filter bags, belts, electric components, motors.
- Use of machine for a purpose other than which it was designed and intended, and use of machine in excess of design duration.
- Damage in transit.

7. Warranty Claim Procedure. If a difficulty develops during the specified warranty period, contact the authorized Cleanfix distributor/partner from whom the machine was originally purchased. Do not return any products to Cleanfix unless explicitly authorized by Cleanfix. Cleanfix may elect to require the return of the machine or component(s) to validate the claim. Any defective machine or component to be returned must be shipped freight pre-paid to an authorized Cleanfix distributor/service center.

Cleanfix will provide and charge for replacement parts, including shipping and handling, to the original purchaser through an authorized service center. If the part is returned within 30 days and is found defective, the purchaser will be credited for the cost of the replacement part including shipping and handling.

8. Term. This warranty is valid for all products sold after January 1, 2006. A product sold before that date will be covered by the limited warranty in effect at the date of sale to the original purchaser.