

ITEM NO.	PART NO.	DESCRIPTION	QTY.	MSRP
1	P561	cap, 6", threaded, w/ 2" npt	1	\$23.99 ea
2	G031	gasket, 3.25" i.d. x 5.88" o.d.	1	\$6.99 ea
3	H359	basket, strainer, 4.5 DIA x 12.5	1	\$36.99 ea
4	P563	filter, body, inline, w/2" npt	1	\$34.99 ea
5	P685	inlet, 2"	2	\$10.99 ea
6	G211	rubber feet, 1-1/8" bas diag, 1" height	4	\$3.99 ea
7	H256	screw, #10-32 x 3/4" phil pan head, zinc	4	\$0.99 ea

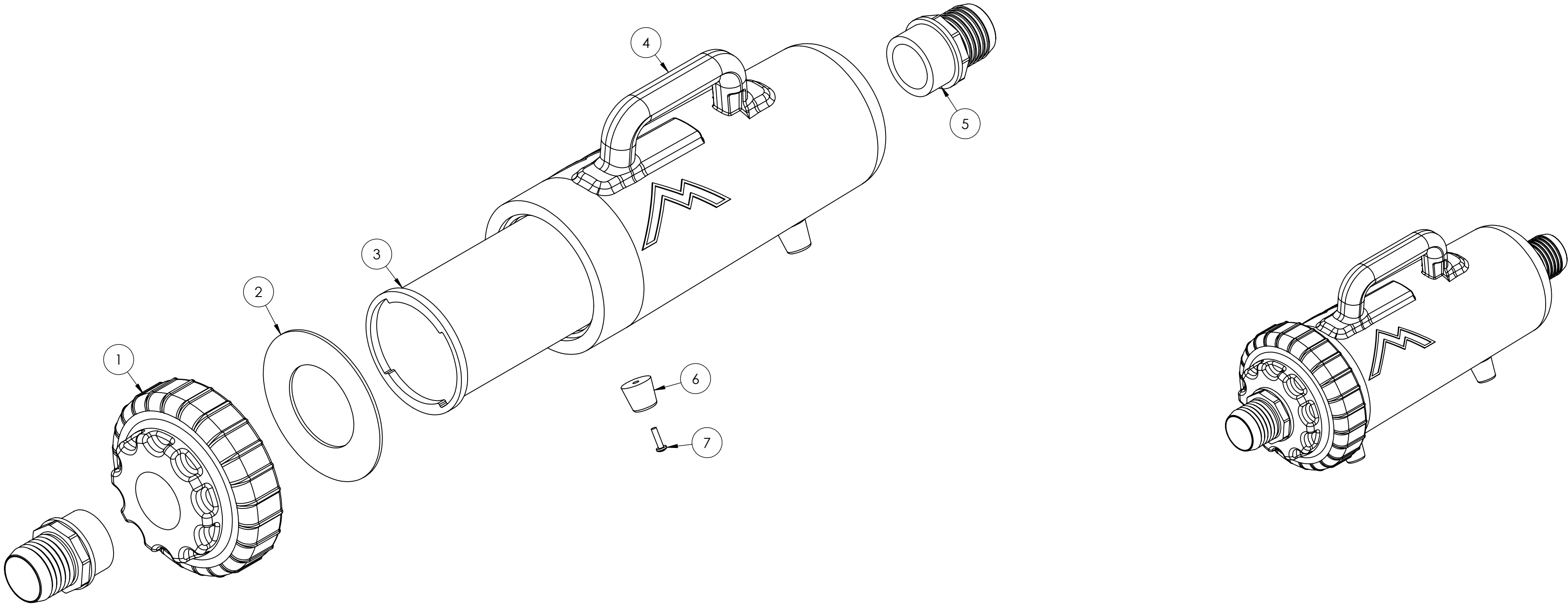

PROPRIETARY AND CONFIDENTIAL
THE INFORMATION CONTAINED IN THIS
DRAWING IS THE SOLE PROPERTY OF
MYTEE PRODUCTS, INC. ANY
REPRODUCTION IN PART OR AS A WHOLE
WITHOUT THE WRITTEN PERMISSION OF
MYTEE PRODUCTS, INC. IS
PROHIBITED.

UNLESS OTHERWISE SPECIFIED:		NAME	DATE	<div>MYTEE PRODUCTS, INC.</div> <div>858-679-1191</div>
DIMENSIONS ARE IN INCHES TOLERANCES:	DRAWN	M. LaBarbera	4/2010	
ANGULAR: MACH ± .5° ONE PLACE DECIMAL ±.03 TWO PLACE DECIMAL ±.05 THREE PLACE DECIMAL ±.003	CHECKED			
MATERIAL	COMMENTS:			
FINISH				TITLE: 2" lint hog
		SIZE	DWG. NO.	REV
		C	F200	OD
		SCALE: 1:3	DO NOT SCALE DRAWING	SHEET 1 OF 1