

A144 Mytee Dry™ GT Change Over Kit

Installation Instructions

The A144 Mytee Dry™ GT change over kit allows you to transform your 8400M tool into the 8400GT.

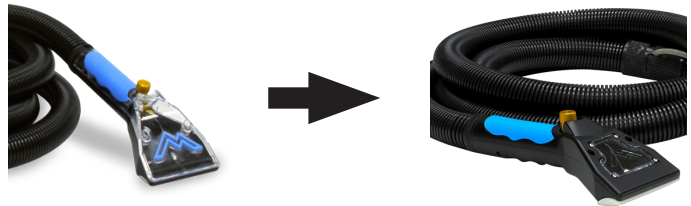

This kit includes:



**Mytee Dry™ GT Top
Housing**



Comfort Grips (pack of 2)
Part Number G166



Glide
Part Number P601A



Glide Gasket
Part Number G112



**4x 6-32 x 1/2" Phillips
Screws**
Part Number H356



**2x #4 x 3/8" Phillips
Screws**
Part Number H031

Tools required for assembly:

- #1 Size Phillips Head Screwdriver
- #2 Size Phillips Head Screwdriver
- Flathead Screwdriver

A144 Mytee Dry™ GT Change Over Kit



1. Remove the plastic top from the tool by removing the four body screws.

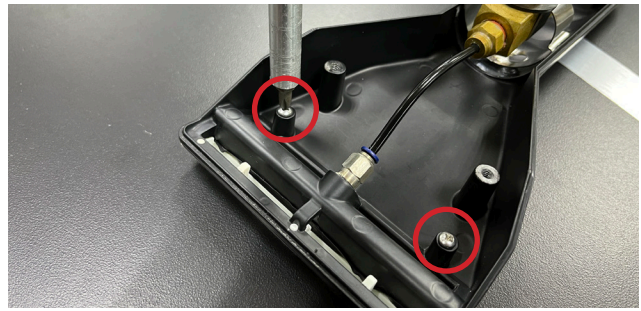

2. Remove the two screws holding the metal glide in place. Pry the glide off the housing using a flathead screwdriver.



3. Ensure the glide gasket is in position. Place the new PTFE glide onto the housing. Press it all the way on. Use the two H031 screws to secure the glide.



4. Place the valve in position on the valve stand and make sure the hose is seated in the swivel grooves on the housing.



5. Lower the new metal housing top onto the bottom half. Make sure the hose swivels freely. Fasten the housing together with the four H356 screws.



6. Choose either the blue or black comfort grip. Peel it off and stick it on the tool in the indented area. It's recommended to clean the area off with some alcohol first.